

Safety Loop. There is a hole through the belt clip. For extra security, we suggest to place a strap through the hole and tie it to your belt to help protect the pedometer from being lost.

Replacing your Battery

Battery Compartment
Screw located on the side
of the case



When the numbers on the display fade out or disappear, it is time to replace the battery. The M-307 uses battery type RW392 or equivalent.

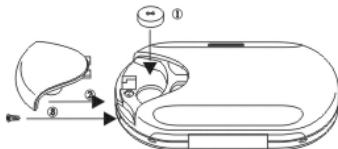

Carefully remove the small screw located on the left side of the case. Slide the cover off and remove the old battery. Keep the used battery out of reach of children and properly discard it separate from other types of waste. Insert the new battery into the battery holder with the positive (+) side up. Slide the cover back into position and tighten the screw. Be careful not to over-tighten screw. This may cause it to strip.

**LIMITED WARRANTY
OUR BASIC POLICY**

Marshall-Browning International Corporation (MBI Corp.) warrants to the original owner, this quartz digital liquid crystal display pedometer (excluding battery, lens, cover, case or clip) for the period of one year from the original purchase date. This limited warranty is given by MBI Corp. and not by the dealer from whom the pedometer was purchased.

THE WARRANTY PROCESS—WHAT IS COVERED BY THE WARRANTY

If the pedometer develops a manufacturing defect within the one-year limited warranty period, it will be either repaired or replaced (at MBI Corp.'s option) with a pedometer of equal or greater value, providing the original owner submits the following:

1. Proof of purchase, i.e. a validated store receipt showing date of purchase.
2. A check or money order (no cash, please) in the amount of \$7.50 to cover the cost of shipping and handling.

WHAT IS NOT COVERED BY THE WARRANTY

- A. MBI Corp. will not repair defects or damages caused by or showing evidence of:
1. Improper or unauthorized service.
 2. Misuse, tampering, abuse, or mistreatment of the pedometer.
 3. Damage to the case or visible cracking of the lens or cover.
 4. Moisture damage.

B. If we find that the battery is the cause of the defect, MBI Corp. reserves the right to charge you (\$7.50) for a new replacement.

MBI Corp. is not liable for incidental or consequential damages. Some states do not allow the exclusion or limitation of incidental or consequential damages, so the above limitation may not apply to you.

YOUR RIGHTS UNDER IMPLIED WARRANTIES AND STATE LAW.

MBI Corp. limits the duration of any warranty implied by state law, including the implied warranty of merchantability, to one year from the date of original purchase. Some states do not allow limitations on how long an implied warranty lasts, so the above limitation may not apply to you. This warranty gives you specific legal rights, and you may also have other rights that vary state to state.

CARING FOR YOUR PEDOMETER

- Proper care of your pedometer will provide many years of enjoyment. We recommend that:
1. The battery be replaced at once when it becomes depleted. Please ask your local retailer to replace the battery for you using an RW 392 or equivalent.
 2. The lens be replaced immediately if it becomes damaged, as contamination from dust, moisture, and other foreign substances will damage the module.
 3. Avoid immersing or exposing your pedometer to water, steam, or other forms of moisture.

WHEN YOU REQUIRE SERVICE

If your pedometer ever requires factory servicing, you can send it directly to:
MBI Corp., 115 Hurlay Road, Oxford, CT 06478.

We strongly recommend that when sending it through the mail, you send the product insured, return receipt requested, so that if a problem in shipping arises, you can trace it through the originating post office. You will be billed for all services performed deemed out of warranty; and since we reserve the right to substitute with a replacement product of equal or greater value, NEVER include a personal item, such as a watchband or carrying case, with the repair request.

Robic offers a complete line of the world's finest timers, stopwatches, pedometers and personal fitness products for all your needs. Please call at (203) 264-2702 for a free catalog.

M-307 Instructions and Operating Guide

Thank you for buying this Robic M-307 Step and Stride Counter. Please read these instructions carefully before using it to ensure safe and correct use.

To ensure the best use out of your Step Counter, do not expose it to direct sunlight, dust, rain, humidity, severe shock or immerse it into water. Do not force open case or belt clip. To open the step counter, hold it in one hand with the spring clip towards your palm, and use the thumb of your other hand to open the case using the lip at the top of the lid. Gently pull the lip forward and the front cover will open.

The M-307 has a single mode of operation:

Step Counter—tracks up to 999,999 steps.

This illustration shows the location and operation of the pushbutton.

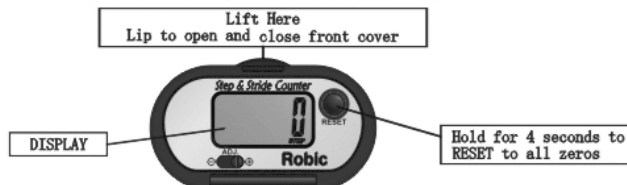

Turn the Power On by gently removing the clear film inserted into the battery compartment. Remove the protective clear cover from the display. Digits will appear on the display.

For the **most accurate results**, the M-307 must be Horizontal to the ground, not angled or dangling from your clothing.

Factors which may result in inaccurate step counting include shuffling, wearing sandals and walking at an inconsistent pace. Remember to keep the case closed when in use.

Position the Step Counter by securely attaching it at waist level to your belt or to the top of your pants or shorts, on the front of your clothing (not at your side.) The case must be closed during use, opened only to view results.

NO!
Angled or Dangling



NO!
Cover/Lid Open



- YES!**
1. COVER CLOSED
 2. LEVEL
 3. HORIZONTAL

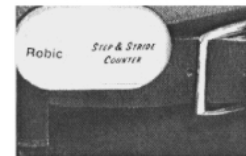

To Use your Robic M-307, put it on and begin walking or running. The M-307 automatically starts and stops when you do.

It will automatically keep count of the number of steps or strides that you have taken since you last RESET the display to all zeros.

Important: Please make sure to record any desired measurement values in writing prior to Resetting your Step Counter to all zeros.

Reset your Step Counter to all zeros by holding RESET for 4 seconds.

Stride Sensitivity Adjustment Depending on your speed, pace or walking style you may need to make your pedometer more or less sensitive to motion by using the ADJ switch. Correctly attach the M-307 to your belt or pants, count your step total and check the reading when stopped. If the count is low compared to your actual total, move towards(+). If the count is high, move the ADJ switch towards(-) as required.



Stride Sensitivity Adjustment

- ⊕ More sensitive
- ⊖ less sensitive